

3" HYDRAULIC SUBMERSIBLE SLIM-LINE PUMP

MODEL

S3A

3" (7.5 cm) Discharge

The S3A is designed to be used as a dewatering pump in areas where space is limited. Typical uses for this pump include manhole, vault, blasthole, mine and construction jobsite dewatering. Used in remote areas as water supply pump.



FEATURES

- Hardened Stainless Steel Impeller resists wear
- Rubber Coated Suction Case resists abrasion
- Small Overall Size allows pump to fit through 8" diameter opening
- Oil Lubricated Seals (can run dry)
- Variable Speed hydraulic drive
- Safe Hydraulic Drive can be used where electric power is hazardous or impractical
- Dependable gear type hydraulic motor
- Operates with our HT16 to HT25 power units or other hydraulic power sources capable of flows to 12 GPM

SPECIFICATIONS

WEIGHT:	41 lbs. (19 kg)
HEIGHT:	19 3/4" (50 cm)
DIAMETER:	7 1/2" (19 cm)
DISCHARGE:	3", NPT(F)
SOLIDS HANDLING:	1/4" (.7 cm)
HOSE PORTS:	1/2" NPT (F)
PUMP BODY:	Anodized Aluminum
IMPELLER:	17-4 PH Stainless Steel
SUCTION CASE:	Rubber Lined
WEAR PLATE:	Polyethylene
SHAFT:	Stainless Steel
SHAFT SEAL:	Silicon Carbide
ELASTOMERS:	Buna N (Std)
HYDRAULIC OIL:	214-320 s.s.u. @ 100°F (64°C)
INPUT FLOW:	Max. 12 GPM (45 LPM)
OPERATING PRESSURE:	Max. 2300 PSI (156 Bar)
POWER SOURCE:	Any Open Center Hydraulic System

D0516

Specifications are subject to change without notice

Model S3A Overall Dimensions

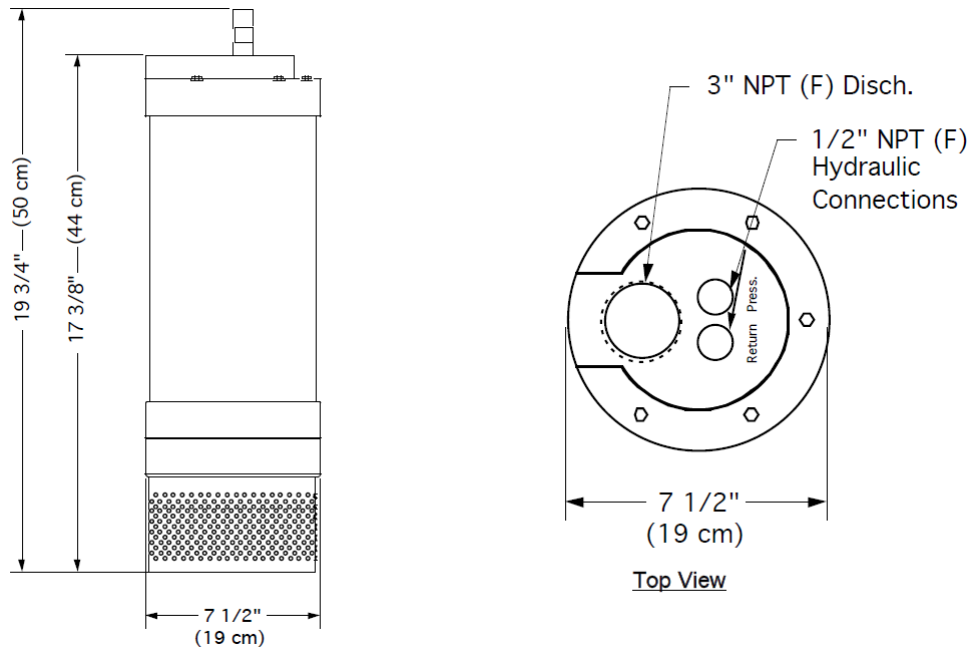

S3A Typical Performance

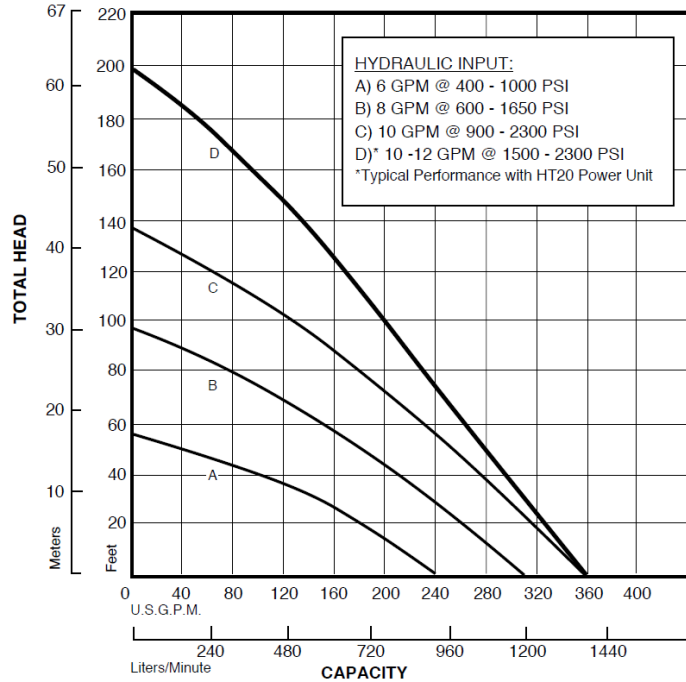

Curves are based on pumping water at 60°F. For performance curves other than shown above, consult factory.