

## 3" HYDRAULIC SUBMERSIBLE VORTEX FLOW TRASH PUMP

### MODELS

**S3T (Aluminum Body)**

**S3TDI (Ductile Iron Body)**

3" (8 cm) Discharge

Our S3T, most popular model, is designed for jobs like construction sites and manhole pumping where lightweight, high volume, trash pumps are needed. It passes through a 12" opening and can pump in debris laden areas. A small hole strainer is available for limiting solids to be pumped.



CE

### FEATURES

- Copied but not duplicated by Desmi, Hycon and others
- Stainless Steel Vortex Flow Impeller
- Oil Lubricated Seals (can run dry)
- Variable Speed hydraulic drive
- Small overall size for use in tight spaces
- Can be bolted directly into a pipeline
- Safe Hydraulic Drive can be used where electric power is hazardous or impractical
- Dependable gear type hydraulic motor
- Operates with our HT11 to HT13 power units or other hydraulic power sources capable of flows of 5-8 GPM
- Stainless Steel model available

### SPECIFICATIONS

WEIGHT S3T:.....	25 lbs. (11 kg)
S3TDI:.....	48 lbs. (22 kg)
HEIGHT:.....	14" (36 cm)
WIDTH (@ widest point):.....	11 3/4" (30 cm)
DISCHARGE:.....	3" NPT(F)
INLET FLANGE:.....	3", 125# ASA
SOLIDS HANDLING:.....	2 1/2" (6 cm)
HOSE PORTS:.....	1/2" NPT (F)
PUMP BODY S3T:.....	Aluminum
S3TDI:.....	Ductile Iron
IMPELLER:.....	Stainless Steel
WEAR RING:.....	Ductile Iron
SHAFT:.....	Plated 4140 Steel
SHAFT SEAL:.....	Carbon/Ceramic (Std)
ELASTOMERS:.....	Buna N (Std)
HYDRAULIC OIL:.....	214-320 s.s.u. @ 100°F (64°C)
INPUT FLOW:.....	Max. 8 GPM (30 LPM)
OPERATING PRESSURE:.....	Max. 2500 PSI (170 Bar)
POWER SOURCE:.....	Any Open Center Hydraulic System

A0317

Specifications are subject to change without notice

## Model S3T Overall Dimensions

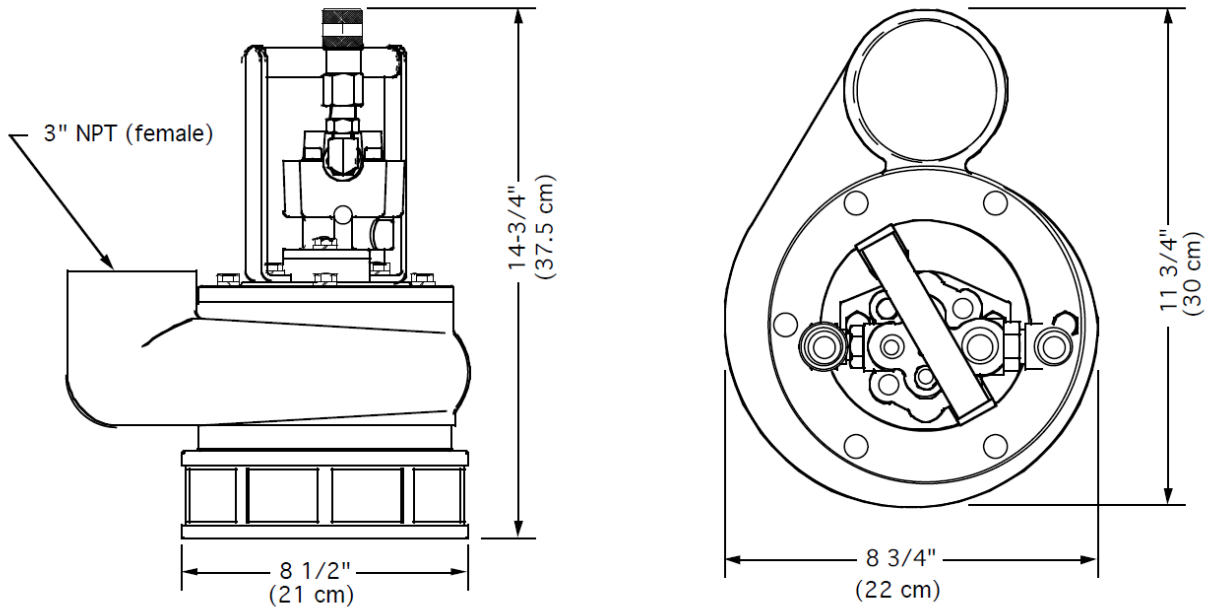

## S3T Typical Performance

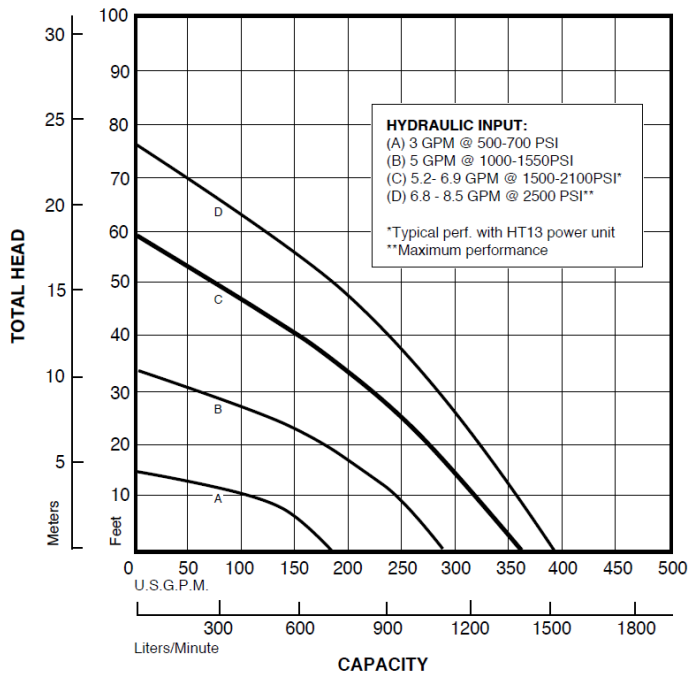

Curves are based on pumping water at 60°F. For performance curves other than shown above, consult factory.

